

S-Mobile200

Handled Laser Scanner Vehicle-Mounted
Platform
Product Manual

202508

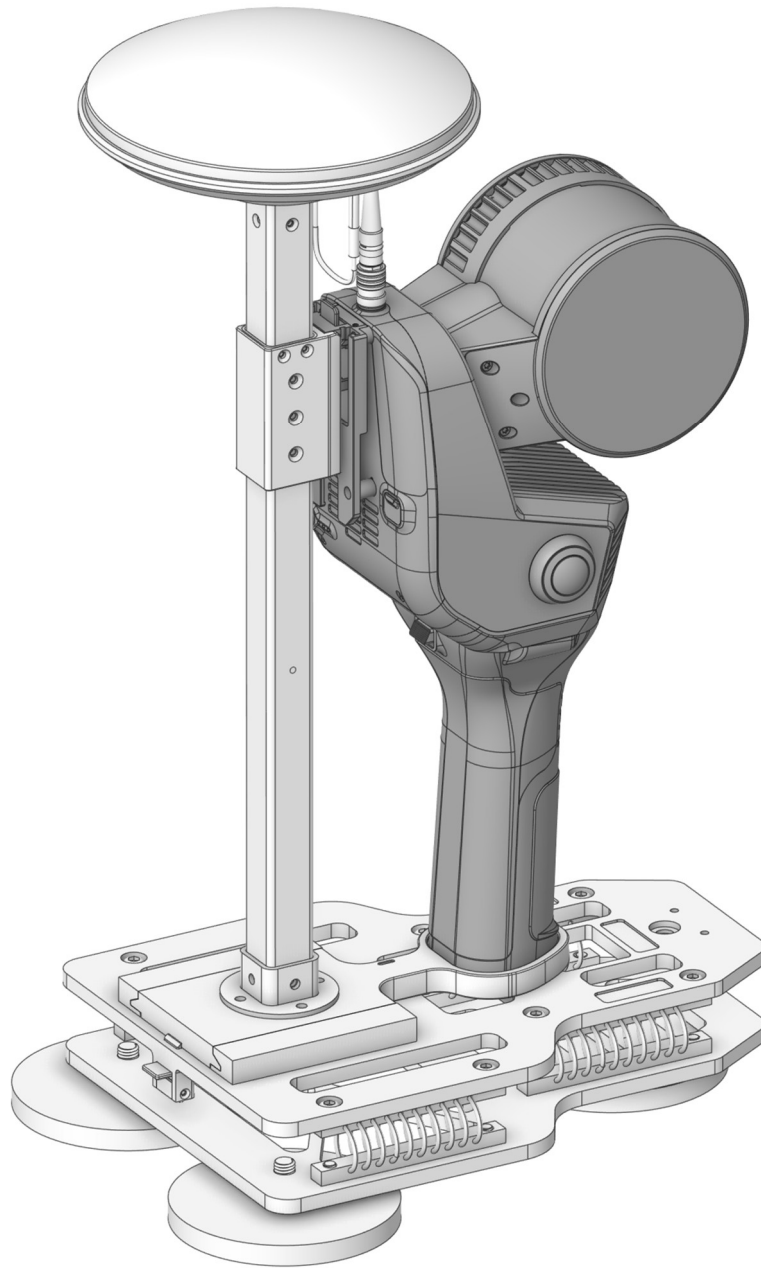

Shenzhen Feima Robotics Co., Ltd.

Disclaimer

Thank you for choosing Feima products. The information contained in this document pertains to your safety, as well as your legal rights and responsibilities. Before using this product, please read this manual carefully to ensure that the device is set up correctly. Failure to follow the instructions and warnings herein may result in injury to yourself or others, and may damage the S-Mobile200 or surrounding property. All rights of interpretation for this document and all related materials of the S-Mobile200 belong to Shenzhen Feima Robotics Co., Ltd. (hereinafter referred to as “Feima Robotics”). This document is subject to change without prior notice.

By using this product, you are deemed to have read, understood, acknowledged, and accepted all terms and content of this disclaimer and warning. You agree to assume full responsibility for the use of this product and any consequences that may result. You commit to using this product only for legitimate purposes and to comply with this disclaimer, as well as any relevant regulations, policies, and guidelines issued by Feima Robotics.

Except as required by applicable laws and regulations in the People’s Republic of China, Feima Robotics shall not be held liable for any loss, injury, or legal responsibility resulting directly or indirectly from the use of this product or this document. Users must follow all safety guidelines mentioned herein and beyond. Feima Robotics reserves the right to modify this manual and the product status at any time. For the latest version of the product manual, please visit our official website: www.feimarobotics.com.



The trademarks in this manual are the property of Shenzhen Feima Robotics Co., Ltd. or its affiliated companies. All product names and brand names mentioned in this manual are trademarks or registered trademarks of their respective owners.

The S-Mobile200 is a precision device. Users are expected to possess basic operational skills and safety awareness and must use the product with caution. Please read the S-Mobile200 manual thoroughly and familiarize yourself with the product's features before operation. Unfamiliar or incorrect usage may lead to equipment damage, property loss, or even personal injury. This product is not intended for use by children. Do not use third-party accessories not supplied or recommended by Feima Robotics. Do not operate the product in any manner inconsistent with the safety instructions described in official documentation provided by Feima Robotics.

This manual contains important safety guidelines, operational instructions, and maintenance information. To ensure safe and proper use of the S-Mobile200, please read this manual and all associated safety warnings carefully before installation, configuration, or operation, and strictly follow the relevant instructions.

Catalog

Disclaimer.....	1
Product Overview.....	4
Components Description.....	4
Main Specifications.....	5
Assemble Description.....	6
Device Assembly.....	6
Installation on Vehicle.....	9
Device Disassembly.....	10
GNSS Antenna Selection.....	12
Cleaning & Maintenance.....	13
Storage Requirements.....	13
Contact Us.....	13

Tips Introduction:

Tips: —Important reminders or suggestions for safe and efficient operation.

Notice! —Important operational notices. Improper handling may cause equipment damage.

⚠ Warning—Critical safety warning. Improper use may result in serious damage or personal injury.

⚠ Warning

- The base of the S-Mobile200 is equipped with a strong magnetic mount. Please take special care to avoid finger pinching when attaching or detaching it from vehicles or other metal surfaces.
- Do not place hands or any other body parts between the magnetic base and metal surfaces under any circumstances.
- When the S-Mobile200 is mounted on a vehicle or other carrier for operation, pay close attention to the height of the GNSS antenna and the vehicle speed to prevent accidents.

Notice!

- The S-Mobile200 is a high-precision device. Dropping or applying external impact may cause damage and lead to malfunction.
- The S-Mobile200 contains strong magnetic components. Please exercise caution and avoid exposing it to magnetic-sensitive environments.
- The S-Mobile200 is not waterproof. Do not use the device in rain, snow, heavy fog, or other humid weather conditions.

Tips:

- The S-Mobile200 vehicle-mounted scanning platform does not include the SLAM200 device mentioned in this manual. Please purchase it separately if required.

Product Overview

The S-Mobile200 is a vehicle-mounted platform for LiDAR scanners developed by Feima Robotics (hereinafter referred to as "the scanning platform"). With a total weight of 2.1 kg, the platform supports the SLAM200 LiDAR scanner for mobile (vehicle-based) operation, significantly enhancing the working efficiency of the SLAM200. By improving operational efficiency, the S-Mobile200 also helps to reduce physical strain on field personnel and greatly expands the flexibility of SLAM200 deployments across various application scenarios.

Components Description

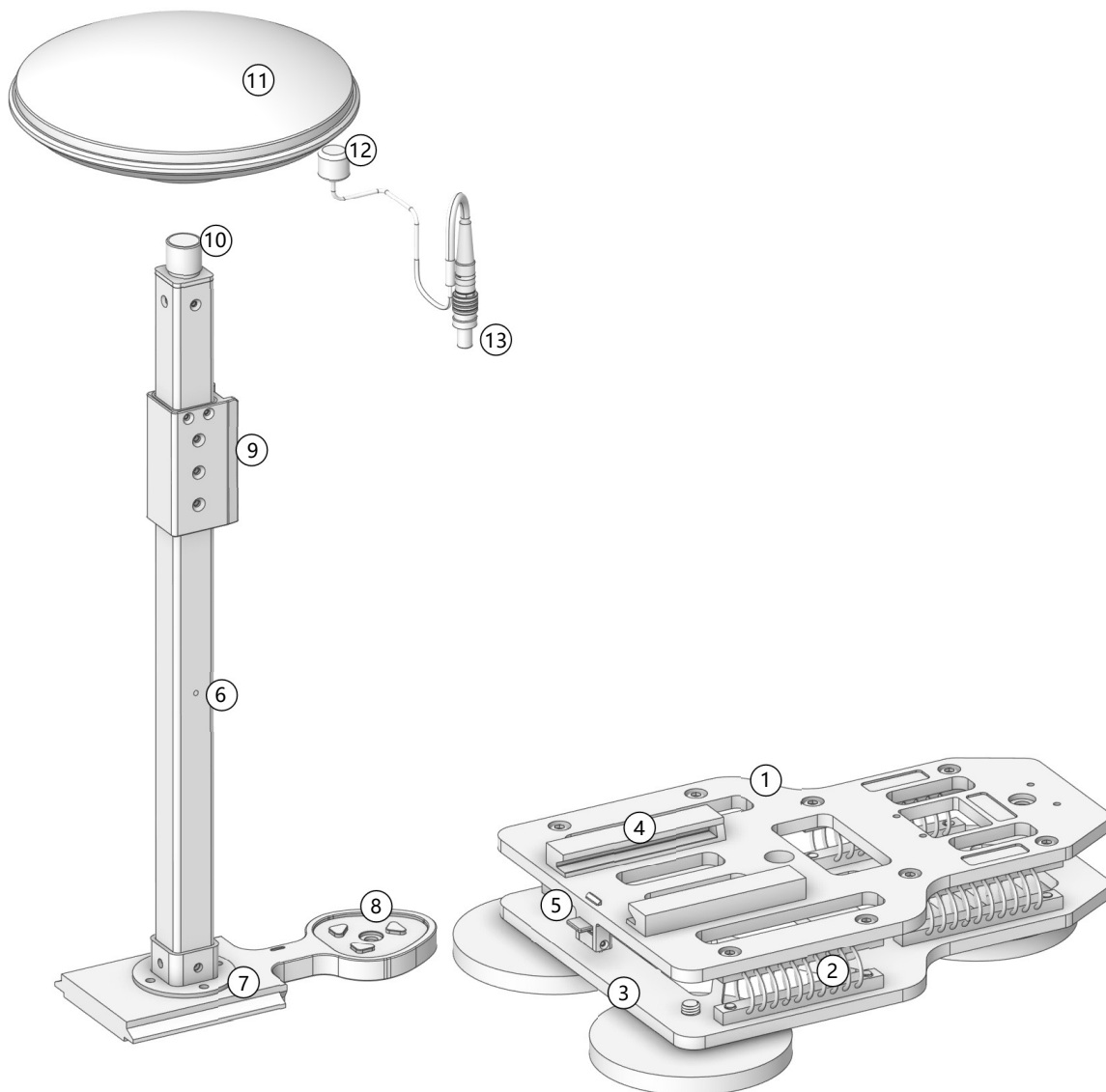

- | | | |
|------------------------------|------------------------------------|---------------------------------------|
| 1. S-Mobile200 Magnetic Base | 6. Scanner Mount Bracket | 11. GNSS Antenna |
| 2. Shock-Absorbing Spring | 7. Bracket Slide Rail | 12. RF Cable Connector (Antenna Side) |
| 3. Strong Magnetic Mount | 8. Mounting Hole (1/4" Screw) | 13. RF Cable Connector (Scanner Side) |
| 4. Base Slot | 9. Scanner Mounting Point | |
| 5. Bracket Release Button | 10. GNSS Antenna Mounting Position | |

Main Specifications

Size(assembled)	269 mm × 208 mm × 458 mm (L × W × H)
Weight	269 mm × 208 mm × 458 mm (L × W × H)
Material	Aviation-grade aluminum
Operation Speed	30km/h (MAX)

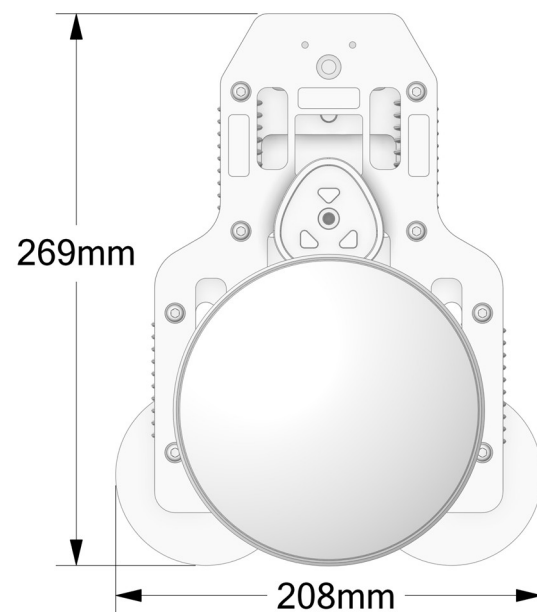
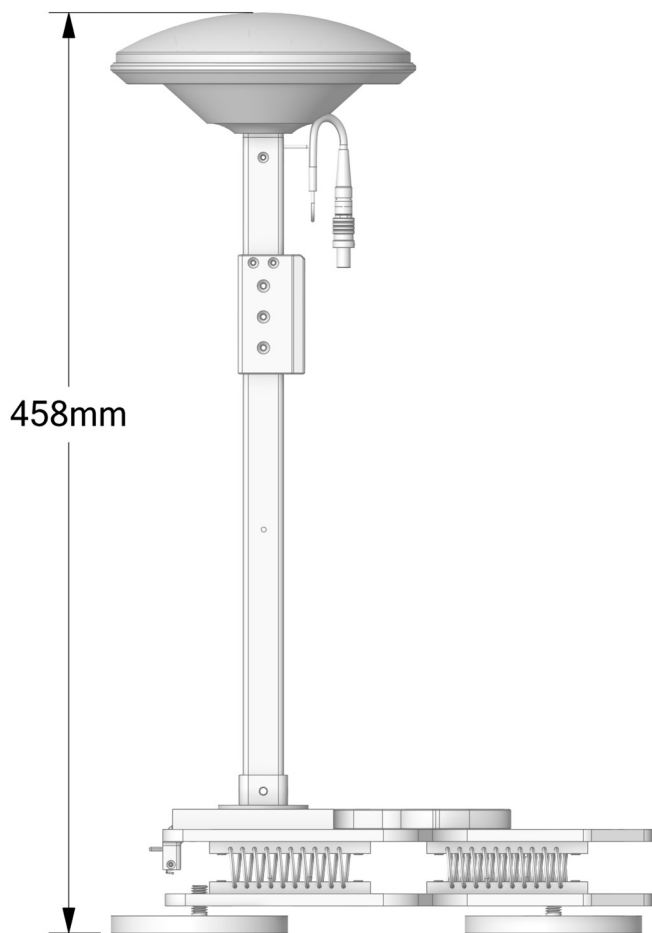

Assemble Description

Device Assembly

1

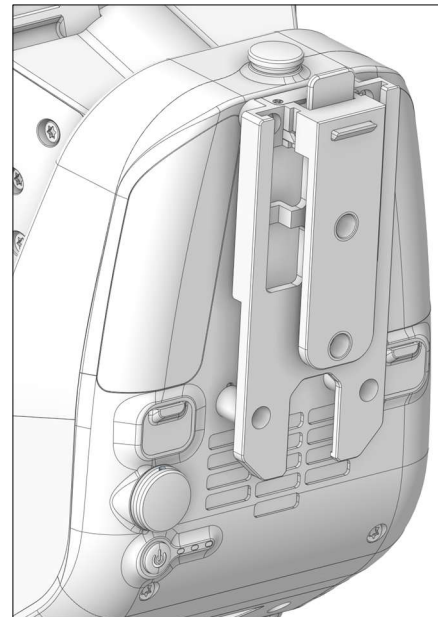
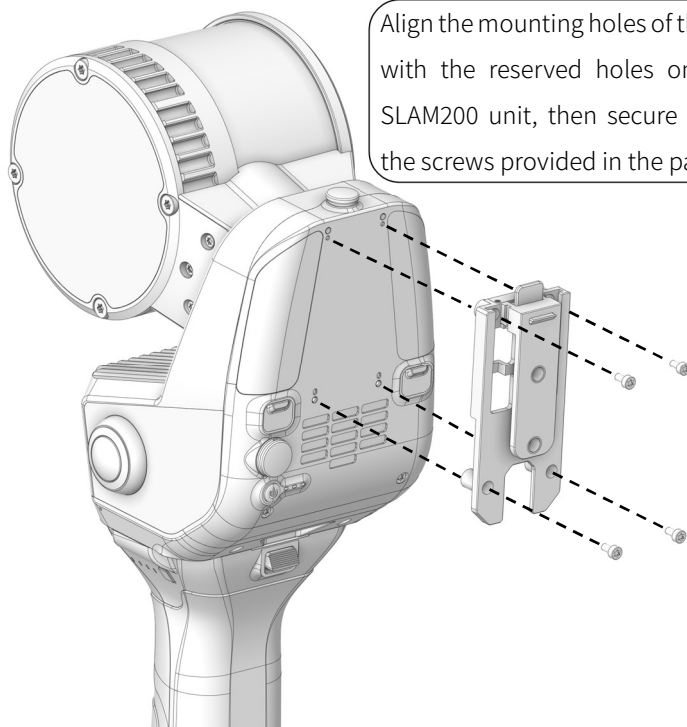

2

Align the scanner bracket slide rail with the mounting slot on the vehicle bracket, then insert it downward into the slot.

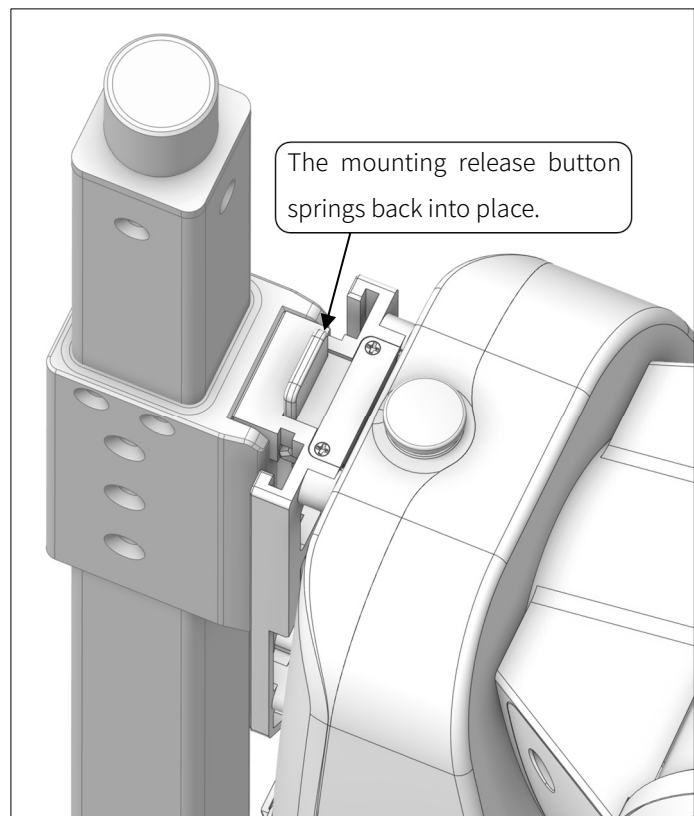
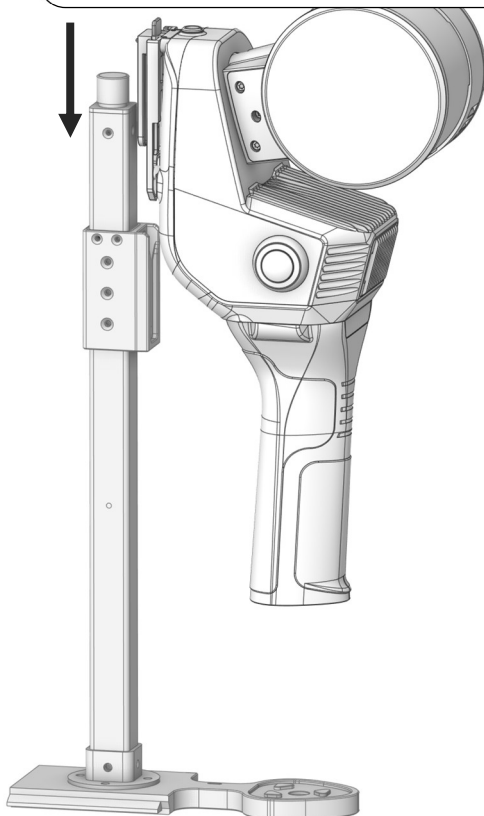

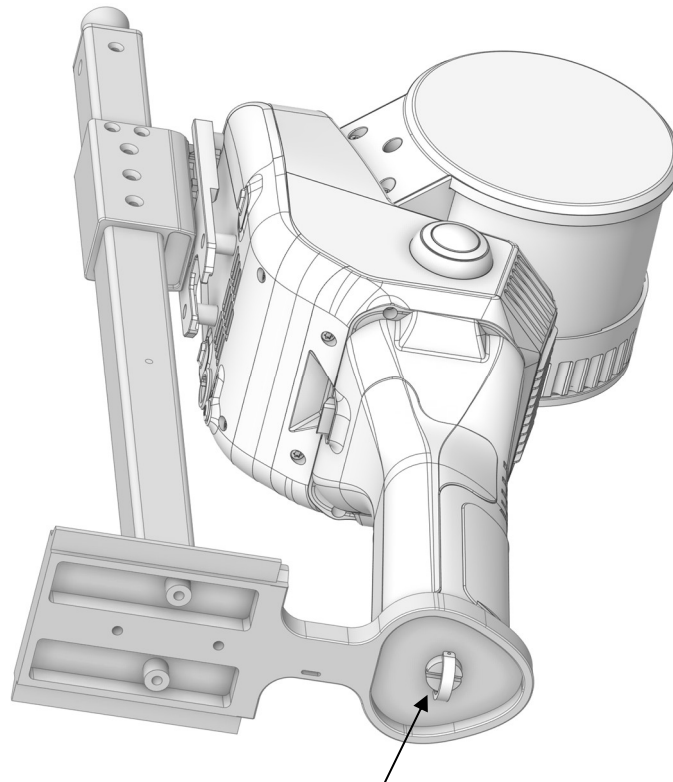

After the scanner is properly installed, please tighten the hand screw at the bottom of the bracket securely.

3

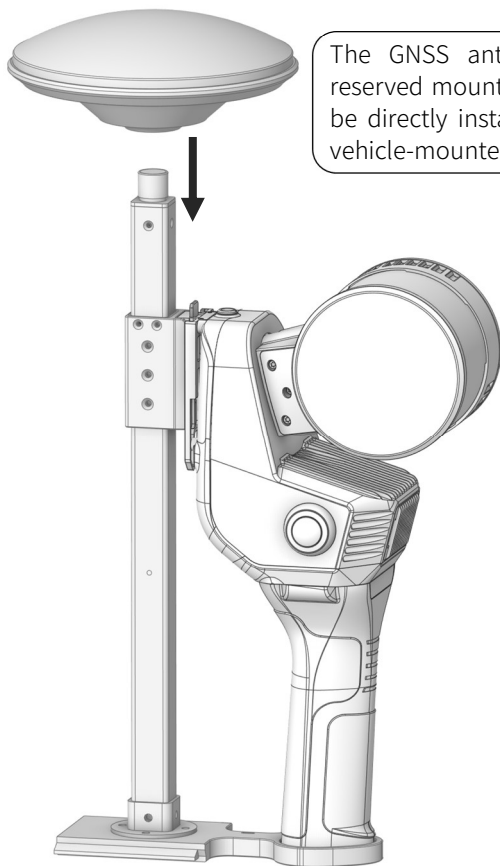

The GNSS antenna base has a reserved mounting thread and can be directly installed on top of the vehicle-mounted bracket.

Remove the dust cap from the SLAM200 antenna connector, then connect both ends of the antenna cable to the GNSS antenna and the scanner respectively.

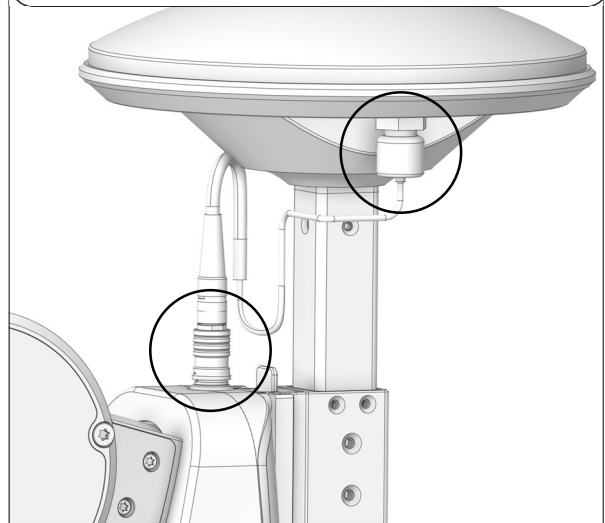

4

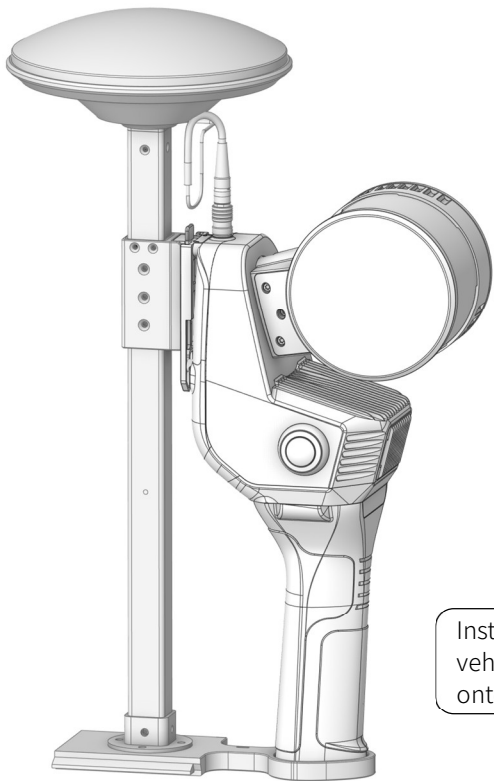

The mounting latch has fully rebounded into place.

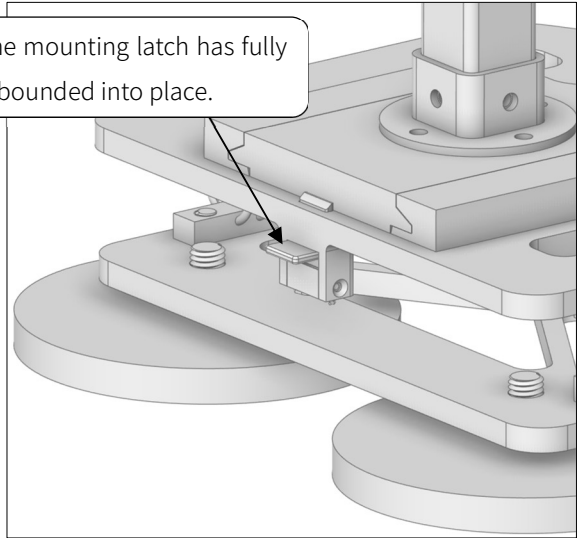

Install the assembled vehicle-mounted bracket onto the magnetic base.

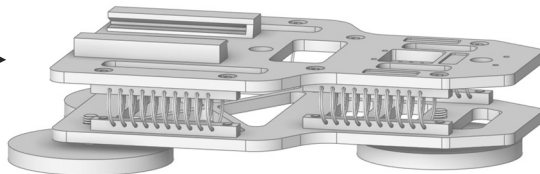

Installation complete

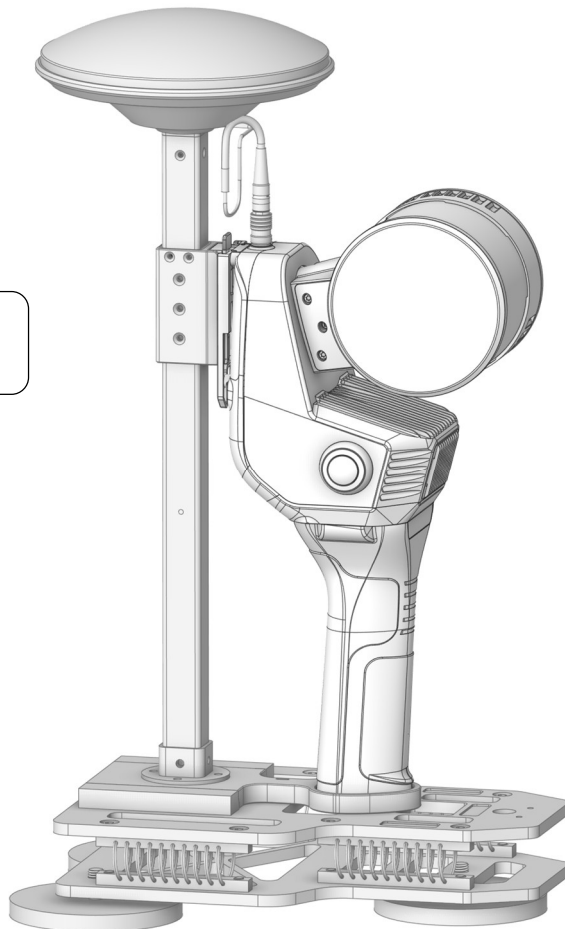

Installation on Vehicle

When placing the S-Mobile200 onto a vehicle or other metal platform with magnetic attachment, please handle with extra care.

Use both hands to firmly grasp the device at the positions indicated in the illustration, and place it down as slowly and gently as possible.

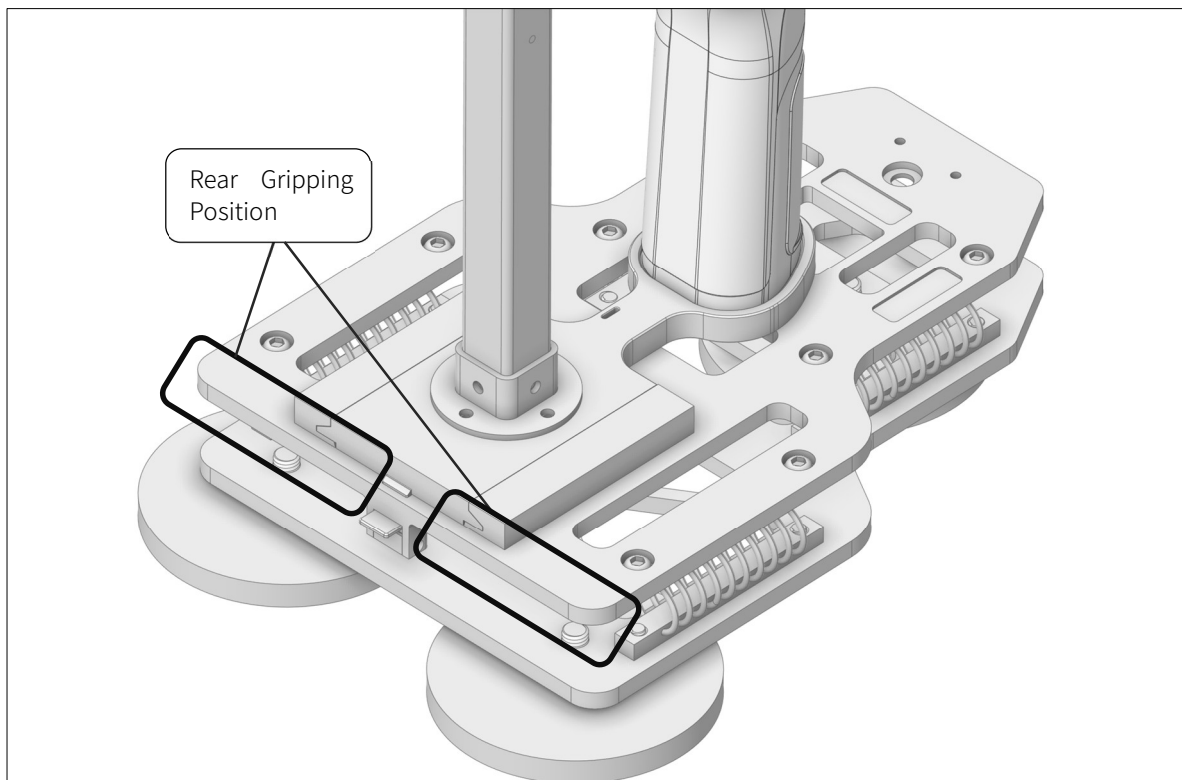
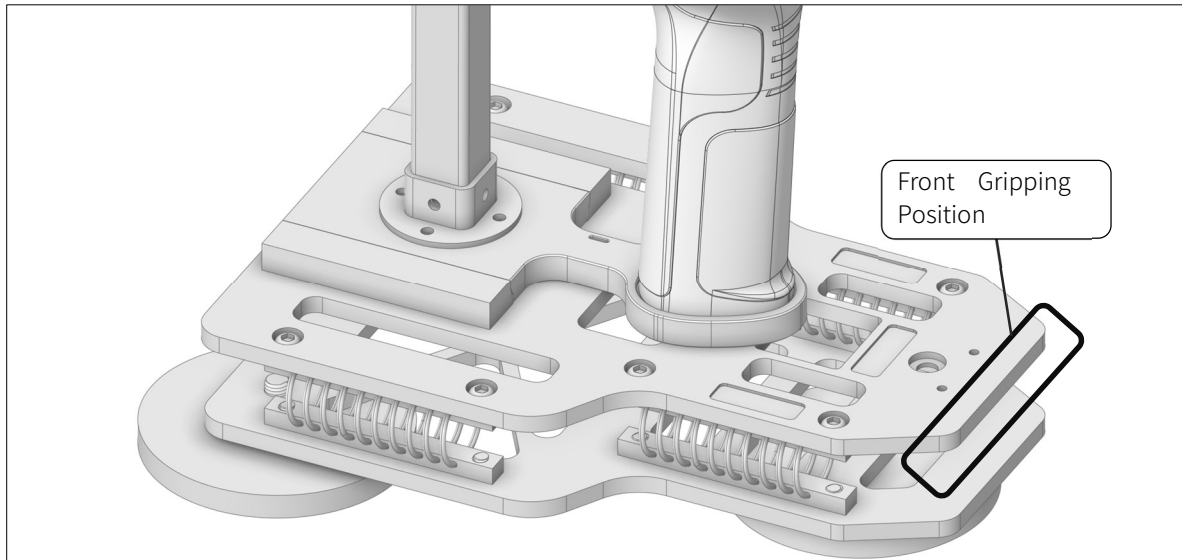

When separating the S-Mobile200 from the vehicle, use both hands to firmly grasp the device at the positions indicated in the illustration.

First, lift the front end of the device with force to detach it from the vehicle, then smoothly separate the entire unit from the vehicle.

⚠ Warning

- The strong magnetic mount has a high metal attraction force. Whether installing or detaching the S-Mobile200, please operate with utmost caution to avoid finger pinching or injury!

Device Disassembly

1

Press down the mounting latch release button.

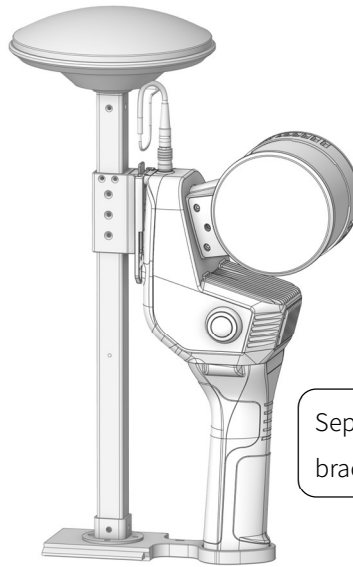
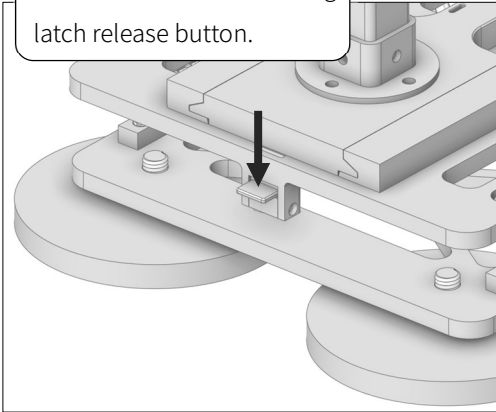

Separate the vehicle-mounted bracket from the magnetic base.

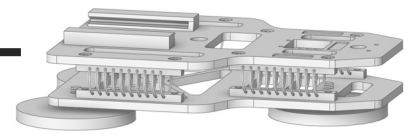

2

Disconnect the antenna cable, detach the GNSS antenna from the vehicle-mounted bracket, and replace the dust cap on the SLAM200 antenna port.

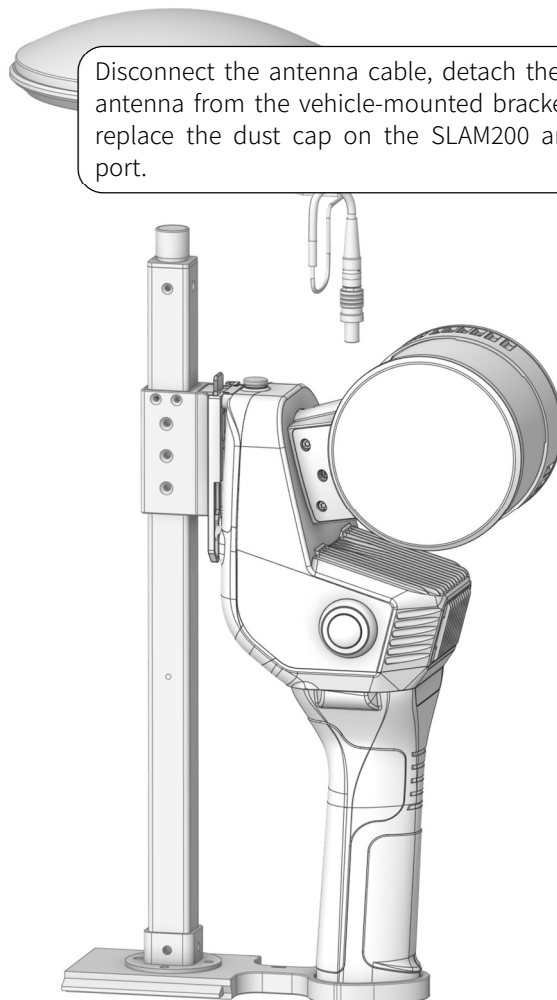

3

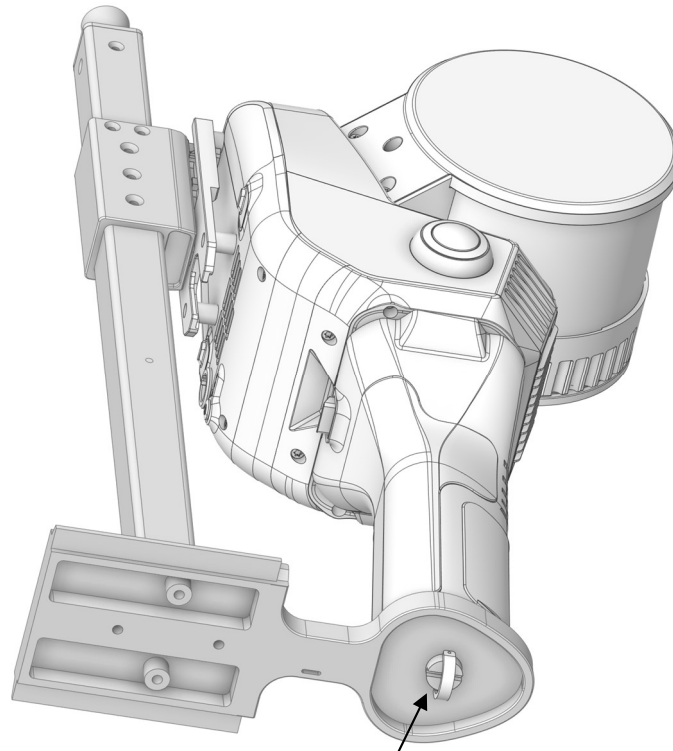

Loosen the hand-tightening screw at the bottom of the bracket.

4

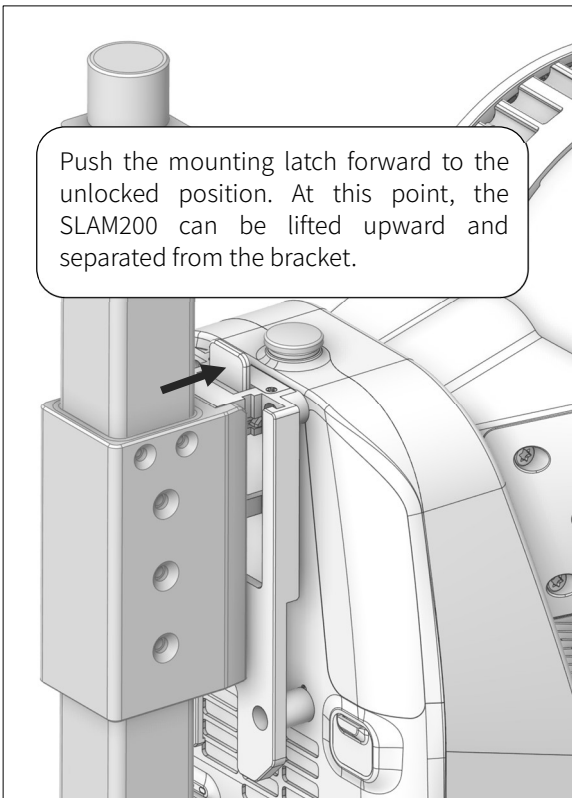

Push the mounting latch forward to the unlocked position. At this point, the SLAM200 can be lifted upward and separated from the bracket.

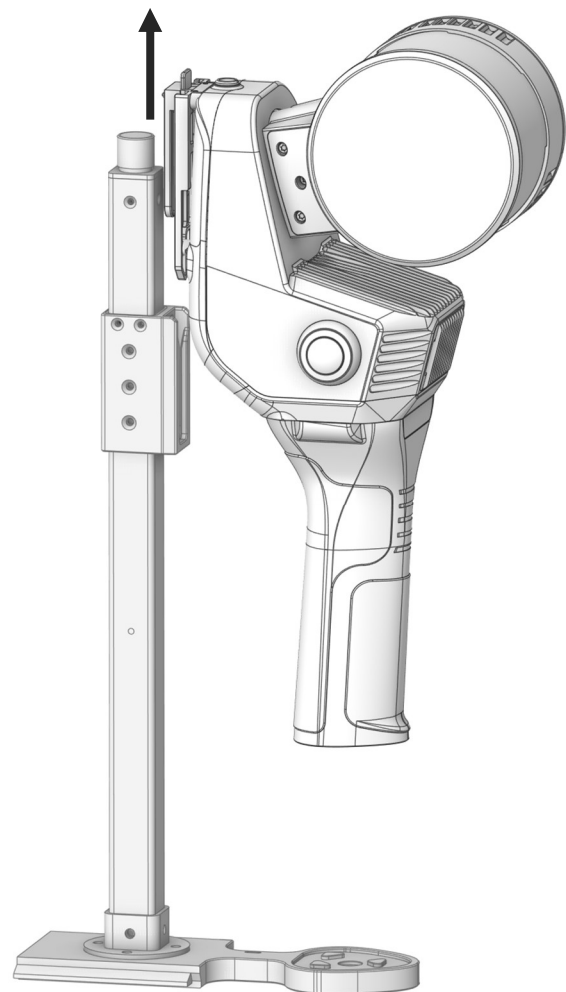

GNSS Antenna Selection

The SLAM200 GNSS antenna can use either the standard antenna supplied with the S-Mobile200 product or the standard antenna supplied with the SLAM200 product.

Example:

Option 1 (Recommended)

Use the standard antenna provided with the S-Mobile200 product.

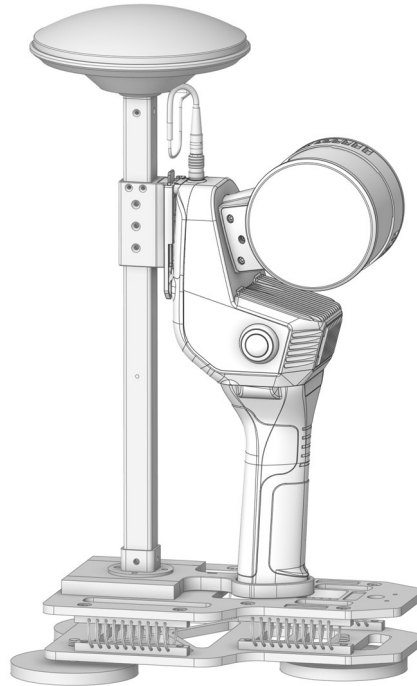

Option 2

Use the standard antenna provided with the SLAM200 product.

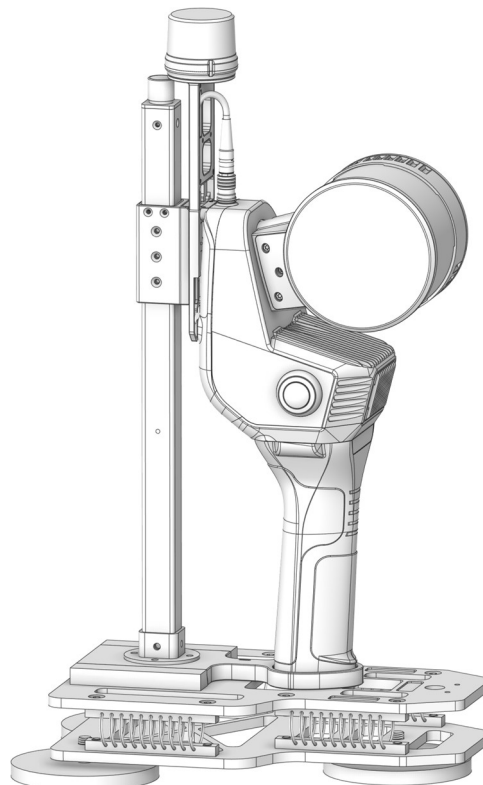

 For more detailed device information, please refer to the SLAM200 Product Manual.

Cleaning & Maintenance

You may use a soft brush to remove dust from the device surface, or wipe it gently with a damp cloth until all dirt is removed.

Notice!

- The S-Mobile200 is not waterproof. Please take special care to protect all device interfaces and GNSS antenna cables during cleaning.

Storage Requirements

- The S-Mobile200 contains strong magnetic components; keep it away from other electronic devices or watches.
- Prevent dropping or impacts.
- Avoid crushing or heavy pressure.
- Store away from humid environments.
- If the device will not be used for an extended period, please store the S-Mobile200 in a safe, dry, and well-ventilated place away from direct sunlight. Avoid excessive humidity that could cause condensation inside the device. Recommended storage temperature is 5°C to 28°C.

Contact Us



If you have any questions or suggestions regarding this manual, please contact us via email: aftersales@feimarobotics.com

www.feimarobotics.com